

JAIL PROJECT
SEPTEMBER 1, 2002 STATUS REPORT TO BOARD OF SUPERVISORS

I. Achievements the past month (August)

A. Construction:

1. Site Work (Contractor: Ferguson Hall): 8-inch waterlines around building have been installed.
2. Precast masonry Cells (Oldcastle):
 - a. Cell molds have been modified to meet the County cell specification.
 - b. Prototype cell produced and inspected on August 16. Two defects were noted as follows: one air duct location was incorrect (Oldcastle has changed to comply with specification), and the glass in lens of the cell lighting fixture was eliminated leaving only the unbreakable polycarbonate lens (identical to what is used in the existing jail). Manchester plant now in full cell production.
3. General Contractor (Horning Construction):
 - a. All exterior foundation walls and footings complete except for a portion of SB6.
 - b. Exterior & interior load bearing masonry walls completed in SB-2 with the exception of the wall along the central corridor.
 - c. Concrete slabs for cells have been completed for Housing Units HB, HC, Hd, HE, and HF.
 - d. Stair tower masonry completed for Housing Unit HB, where load bearing wall has also been started.
4. Structural Steel & Miscellaneous Metal Contractor (Rochester Rigging & Erectors): Supplier has begun fabrication of steel deck and structural joists.
5. Plumbing & Fire Suppression Contractor (Ferrauilo Plumbing & Heating):
 - a. Underground piping (sanitary and water supply) completed in Housing units HB, HC, HD, HE, HF, and HG.
 - b. Deep Underground piping (sanitary & storm) completed in SB2.
6. HVAC Contractor (John W. Danforth): Ductwork for SB1, SB2, & SB6, and the rooftop air handling units, have been delivered to the site.
7. Electrical Contractor (Blackmon Farrell):
 - a. Conduit stub-ups completed in Cell area in Housing Units HB, HC, HD, HE, and HF prior to pouring of concrete slabs for precast cells.
 - b. Deep underground conduit in SB-1 & SB-2 completed.
 - c. In wall conduits installed in masonry walls constructed in SB2.
 - d. Transformer and switchgear installed for primary power supply.
8. Detention Equipment and Electronic Security (Maximum Security Products): Hollow metal door frame delivery has lagged behind the project schedule.

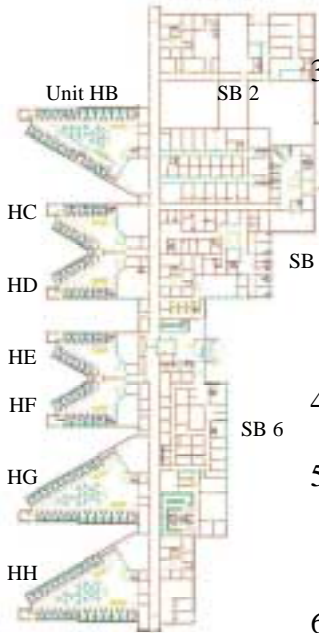

B. Construction Manager (Pike Construction):

1. Revised project schedule to incorporate spring rain delay for adoption by County.
2. Provided 2 new change order requests to the County (smoke detector in ductwork for the electrical contractor, and acceptance of substitute boiler submitted with the HVAC contractor's bid as a \$30,000 deduct).

C. Architect:

1. Modifying 16-inch pipe drawings to incorporate changes requested by the Hopewell Water District.
2. Processed of 196 of 198 contractor requests for information to date. None are overdue.

II. Issues

- A. Water service agreement with Hopewell/Canandaigua Water Districts.

- B. Modification of design of 16-inch waterline around the west side of the jail that will result in an additional change order charge.
- C. Delivery of Hollow Metal Doors by Maximum Security Products has lagged behind schedule. Additional work will be required by the General Contractor as a result, but at no cost to the County.
- D. Production of precast cells has not been as rapid as anticipated by OldCastle. They will still meet the project milestone dates, however. Tasks for contractors that are ahead of schedule have had to be resequenced by the management team (Pike, Carter Goble, and the County) to keep them gainfully occupied.

III. Planned for September

A. Construction Manager:

- 1. Progress meetings held weekly on Tuesday mornings.
- 2. Continue vigilance concerning Hollow Metal Door delivery and coordination

B. Construction/Contractors

- 1. Site work: Ferguson Hall will install the portion of the 16-inch waterline already approved by change order.
- 2. Precast: Has added weekend production to meet project milestones for delivery of cells. Crane scheduled to arrive week of Sept. 15, with cell erection scheduled to begin on Sept. 23.
- 3. General Construction: Completion of load bearing walls in SB1, HC, HD, HE, and HF. Pour cell slabs in HG & HH, pour dayroom slab in HB, and potentially pour day room slabs in HC and HD. Work on stair towers for all the housing units.
- 4. Structural Steel: Delivery of joists for SB1 & SB2 is scheduled for the week of September 16. Joists for housing units to follow soon after.
- 5. Plumbing Work: Underground sewer & water work and stub ups will be completed in HG by the middle of September. Work on “shallow lines” will commence in the laundry and kitchen areas of SB2.
- 6. HVAC: Cell chase ductwork will begin upon delivery and erection of cells.
- 7. Electrical work: Conduit and stub-ups in HG and HH will be done. Deep conduit runs in SB6 will begin.
- 8. Detention Equipment: Will complete delivery of doorframes. Work with masons to install conduit for security equipment (door controls, monitors, intercom system) in concrete block walls in remaining Housing Units are erected.

C. Architect: Will provide report on all material and finish colors selected for October JPC meeting..

IV. Photos



Finishing Cell Slab-HB



Carmen inspecting prototype cell



Walls on SB2 and HB stair tower
This Photo from Horning Construction